

Professional Gigabit phone with Color LCD

SIP-T29G IP Phone is the most advanced model in the Yealink T2x IP terminal series. It has a high-resolution TFT color display, delivers a rich visual experience. Yealink Optima HD technology enables rich, clear, life-like voice communications. Supports Gigabit Ethernet, a variety of device connections, including EHS headset and USB. With programmable keys, the IP Phone supports vast productivity enhancing features.



Optima
HD Voice



Gigabit



Paperless



Support
Bluetooth Earphone



Key Features and Benefits

New updated and improved model

Yealink's SIP Phones continue to evolve, the function of new SIP-T2 Series has become more abundant, the new user-interface with color display has become more friendlier.

HD Audio

Yealink Optima HD Voice refers to the combination of software and hardware design as well as the implementation of wideband technology to maximize the acoustic performance. Coupled with advanced acoustic clarity technology such as full duplex, echo cancellation, adaptive jitter buffer etc. Creating an amazing face-to-face live experience.

A rich visual experience for applications

SIP-T29G Supports vast productivity-enhancing feature such as XML Browser, SCA, BLF List, call forward, call transfer, 3-way conferencing, the 4.3 inch backlit color display enables rich visual presentation and easier navigation of the menu. Three pages of 10 flexible buttons are shown on the display can be programmed up to 27 various features.

Advanced connectivity and expandability

For network connectivity, the SIP-T29G comes with two Gigabit Ethernet ports, one of them suitable for Power over Ethernet. Supports a variety device connections, including EHS headset and USB. User enable Bluetooth headset through USB Dongle.

Supports up to 6 Expansion Module, adding up to 240 additional buttons with a screen based LCD display and LED system.

Highly secure transport and interoperability

The Communicator uses SIP over Transport Layer Security (TLS/SSL) to provide service providers the latest technology for enhanced network security. The range is certified compatible with 3CX, Asterisk and BroadSoft Broadworks, ensuring excellent compatibility with leading soft switch suppliers.

- Yealink Optima HD voice
- Dual-port Gigabit Ethernet
- 4.3" 480 x 272-pixel color display with backlight
- Built-in a USB port, support Bluetooth headset (Through USB Dongle)
- Up to 16 SIP accounts
- Paper label free design
- PoE support
- Headset, EHS support
- Supports expansion modules
- Stand with 2 adjustable angles
- Wall mountable (optional)
- Simple, flexible and secure provisioning options

Audio Features

- > HD voice: HD handset, HD speaker
- > Codecs: G.722, G.711(A/μ), G.723, G.729AB, G.726, iLBC
- > DTMF: In-band, Out-of-band(RFC 2833) and SIP INFO
- > Full-duplex hands-free speakerphone with AEC
- > VAD, CNG, AEC, PLC, AJB, AGC

Phone Features

- > 16 VoIP accounts
- > Call hold, mute, DND
- > One-touch speed dial, hotline
- > Call forward, call waiting, call transfer
- > Group listening, SMS, emergency call
- > Redial, call return, auto answer
- > 3-way conferencing
- > Direct IP call without SIP proxy
- > Ring tone selection/import/delete
- > Set date time manually or automatically
- > Dial plan
- > XML Browser
- > Action URL/URI
- > Integrated Screenshots
- > RTCP-XR

Directory

- > Local phonebook up to 1000 entries
- > Black list
- > XML/LDAP remote phonebook
- > Intelligent search method
- > Phonebook search/import/export
- > Call history: dialed/received/missed/forwarded

IP-PBX Features

- > Busy Lamp Field (BLF)
- > Bridged Line Appearance(BLA)
- > Anonymous call, anonymous call rejection
- > Hot-desking
- > Message Waiting Indicator (MWI)
- > Voice mail
- > Call park, call pickup
- > Intercom, paging
- > Music on hold
- > Call completion
- > Call recording

Display and Indicator

- > 4.3" 480 x 272-pixel color display with backlight
- > 16 bit depth color
- > LED for call and message waiting indication
- > Dual-color (red or green) illuminated LEDs for line status information
- > Wallpaper
- > Intuitive user interface with icons and soft keys
- > National language selection
- > Caller ID with name, number and photo

Feature keys

- > 10 line keys with LED
- > 10 line keys can be programmed up to 27 various features (3-page view)
- > 8 features keys: message, headset, conference, hold, mute, transfer, redial, hands-free speakerphone
- > 4 context-sensitive "soft" keys
- > 6 navigation keys
- > Volume control keys
- > Illuminated headset key

Interface

- > Dual-port Gigabit Ethernet
- > Support Bluetooth headset through USB Dongle
- > 1 x RJ9 (4P4C) handset port
- > 1 x RJ9 (4P4C) headset port
- > 1 x RJ12 (6P6C) EXT port: Supports up to 6 Expansion Modules for an attendant console application
- > Power over Ethernet (IEEE 802.3af), class 0

Other Physical Features

- > Stand with 2 adjustable angles
- > Wall mountable
- > External universal AC adapter (optional): AC 100~240V input and DC 5V/2A output
- > Power consumption (PSU): 1.8-5.4W
- > Power consumption (PoE): 2.1-8.0W
- > Dimension (W*D*H*T): 244mm*213mm*185mm*54mm
- > Operating humidity: 10~95%
- > Operating temperature: -10~50°C

Management

- > Configuration: browser/phone/auto-provision
- > Auto provision via FTP/TFTP/HTTP/HTTPS for mass deploy
- > Auto-provision with PnP
- > BroadSoft device management
- > Zero-sp-touch, TR-069
- > Phone lock for personal privacy protection
- > Reset to factory, reboot
- > Package tracing export, system log

Network and Security

- > SIP v1 (RFC2543), v2 (RFC3261)
- > Call server redundancy supported
- > NAT transverse: STUN mode
- > Proxy mode and peer-to-peer SIP link mode
- > IP assignment: static/DHCP/PPPoE
- > HTTP/HTTPS web server
- > Time and date synchronization using SNTP
- > UDP/TCP/DNS-SRV(RFC 3263)
- > QoS: 802.1p/Q tagging (VLAN), Layer 3 ToS DSCP
- > SRTP for voice
- > Transport Layer Security (TLS)
- > HTTPS certificate manager
- > AES encryption for configuration file
- > Digest authentication using MD5/MD5-session
- > OpenVPN, IEEE802.1X
- > IPv6

Package Features

- > Qty/CTN: 5 PCS
- > N.W/CTN: 6.5kg
- > G.W/CTN: 7.3kg
- > Giftbox size: 300mm*225mm*118mm
- > Carton Meas: 610mm*310mm*238mm

Certifications

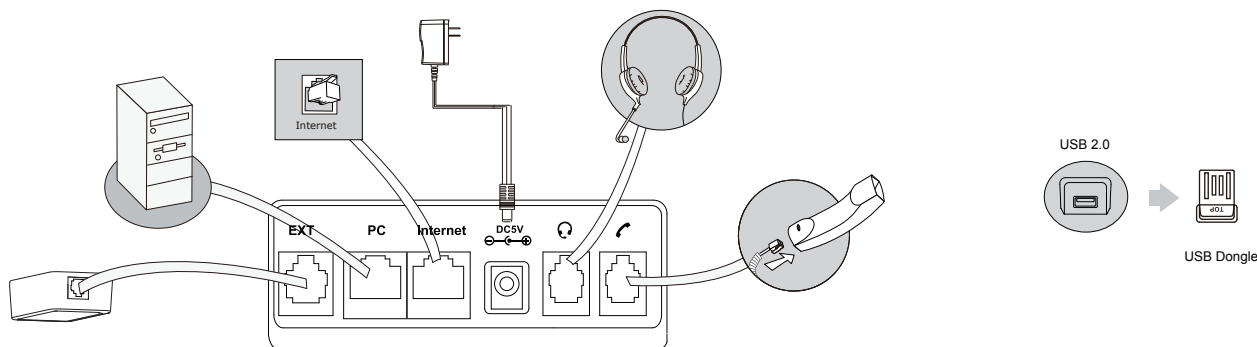

Learn More

To find out how Yealink solutions can help your organization, visit us at www.yealink.com or mail to sales@yealink.com